

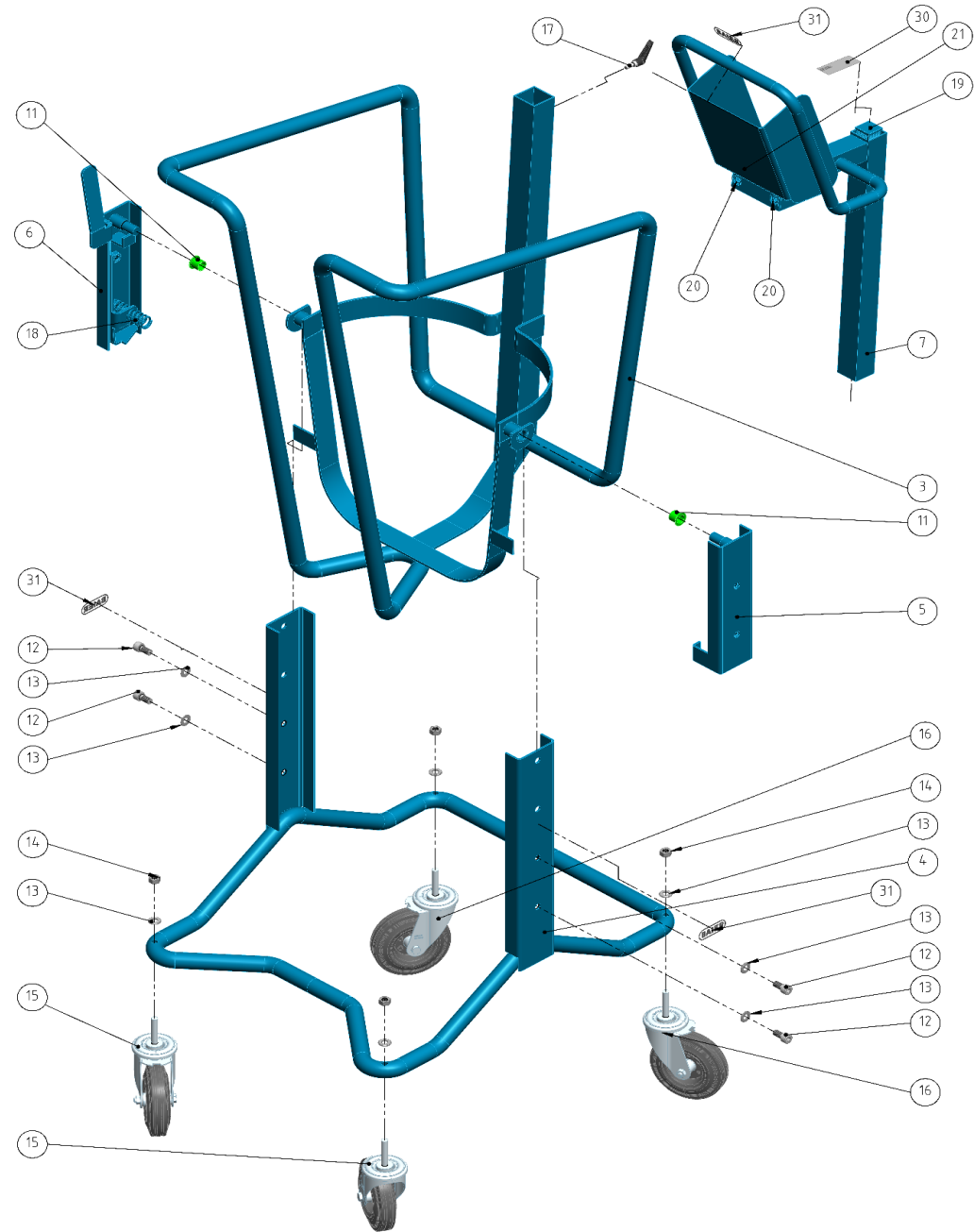

POS	IDNR	DESCRIPTION	qty
1	9778	BUCKET	1
2	9780	DUST COVER	1
3	9768	UPPER FRAME CPL.	1
4	9756	LOWER FRAME CPL.	1
5	9745	HEIGHT ADJUSTMENT LEFT CPL.	1
6	9749	HEIGHT ADJUSTMENT RIGHT CPL.	1
7	9776	THREAD CPL.	1
11	9802	BEARING	2
12	48843	HEXAGONE SCREW M10x20 DIN913	4
13	8117	WASHER M10 DIN125 GALV.	8
14	30213	NUT M10 DIN985	4
15	9798	WHEEL Ø125MM, WITHOUT BRAKE	2
16	9799	WHEEL Ø125MM, WITH BRAKE	2
17	9658	CLAMPING LEVER M8	1
18	9801	PRESSURE SPRING D207	1
19	9800	END PLUG V40	1
20	8112	HEXAGONE SCREW M10x80 DIN912	2
21	19489	HEXAGONE SCREW M6x16 DIN912	2
30		TYPE SIGN	1
31	31088	COMPANY SIGN	3
	32144	HEXAGONE WRENCH SW8	1
	3384	WRENCH 13/17	1
	9873	WRENCH SW15	1
	9806	STIRRER Ø225mm 1/1	1
	9916	STIRRER Ø225mm 1/2	1
	9778	SPARE BUCKET	1
	9871	TRANSPORT WHEELS (AIR)	1
	9566	HIGH-SPEED MIXER BSM2868	1

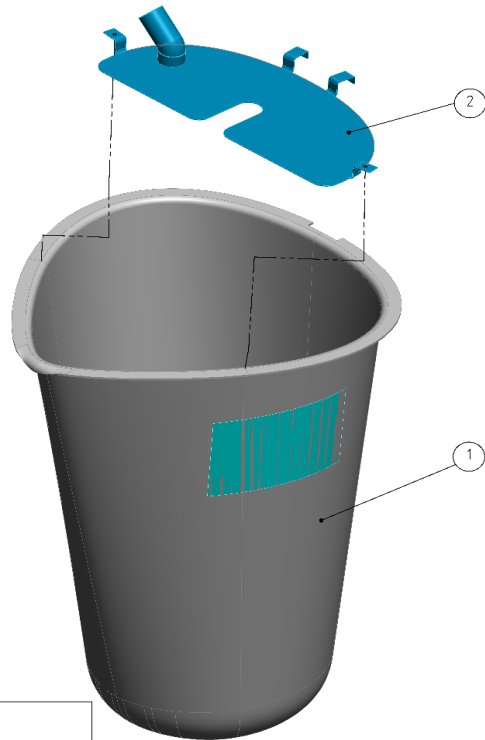

Ersatzteilzeichnung
 SPARE PARTS DRAWING
 Mischstation BMK120
 GIANT 120
 Id. 9781 ab/from Masch-Nr. 0
 Stand/status: 2020.11
 ersetzt/replaced: 07.2019



ZUBEHOER
 ACCESSORIES

ID-NR.	BENENNUNG DESCRIPTION	ANZAHL QUANTITY
32144	I-6-KT-SCHLUESSEL SW8	1
3384	GABELSCHLUESSEL 13/17	1
9873	GABELSCHLUESSEL SW15	1
9806	RUEHRQUIRL Ø225MM 1/1	-
9916	RUEHRQUIRL Ø225MM 1/2	-
9778	ERSATZBEHAELTER	-
9871	TRANSPORTRAEDER	-
9566	RUEHRWERK BSM2868	-