



BSS 608 H
ID-Nr.:09251
ab 01/08/2018

STATUS: 2020.11
REPLACED: -

POS	ArtikelNr.	DESCRIPTION	qty
18	9378	GUIDE SCREW	2
21		HOUSING AIR CIRCULATION ABOVE	1
22	9412	TAB DOUBLE	1
23		ELECTRONIC CONTROL SET	1
25	9397	HANDLE	1
26	9410	ROTARY SWITCH	1
28	9317	FIXING CASE	1
32	9925		
34	9398	HANDLE NUMBER OF REVOLUTIONS / HOSE SELECT	2
35		CIRCUIT BOARD SPEED CONTROL ONLY FOR REP	1
36	9411	PLUG SOCKET	1
37			
40			
42		MAGNET SENSOR SET	1
50	9375	FILTER COVER OEM RAL 5012	1
51	9372	FILTER COVER TOP PART OEM RAL 5012	1
55	9318	ANTISLIP RUBBER SET	1
59	9374	MAGNET COVERING CAP	1
60		FILTER COVER CLOSURE	1
61	9380	BOLT HOOK	2
62	9385	SPRING	1
63	9360	MOULDED PART COVER FILTER	1
64	9366	HOLDER MAGNET	1
65	9413	CABLE MAGNET	1
66		MAGNET 100V	1
			1
67	9359	PLATE MAGNET	1
68	9394	VALVE DISK UL	1
70	9384	SPRING SOFT	1
71	9370	HOLDER FLAT FILTER	1
72			1
72	10019	FLAT-PLEATED FILTER NEUTRALLY PACKAGED	1
73	9369	FRAME FLAT-PLEATED FILTER	1
73	9869		1
74			1
75	9470		1
78			2
80			1
82	10084		2
91	9363	HOLDER ACCESSORIES NW35 RAL 9005	1
92	9414	POWER CABLE RUBBER 7,5m	1
93	8596	FERRITE RING	2
96	9396	COVER HOUSING AIR CIRCULATION RAL 5012	1
98	8605	SEAL VACUUM MOTOR ABOVE	1
99	8606	SEAL VACUUM MOTOR CENTER	1
100	8597	VAC MOTOR 230V	1
101	9387	SEAL BOTTOM DOMEL	1
104		AIR CIRCULATION	1
105	9386	SEAL SUPPLY AIR	1
108		RETAINING BRACKET CABLE	1
111			1
114			1
115			1
116			1
118			1
120	9417	CABLE BROWN 1,5mm ² x200mm	1
121	9418	CABLE BLUE 1,5mm ² x200mm	1
122	9419	CABLE BLUE 1mm ² x270mm	2
123	9420	CABLE BROWN 1mm ² x270mm	2
125	9416	CABLE AWG	2
126			1
127	9421	CABLE GREEN / YELLOW 1,5mm ² x180mm	1
129			1



BSS 608 H
ID-Nr.:09251
ab 01/08/2018

STATUS: 2020.11
REPLACED: -

POS	ArtikelNr.	DESCRIPTION	qty
TANK - PARTS			
130	9474	TANK SET BSS 606 L *EU / *DK	1
131	9376	AXLE	1
132	9367	HOLDER AXLE	2
133	9368	HOLDER FLOOR NOZZLE RAL 7001	1
134	9393	WHEEL D180	2
135	74419	LOCK WASHER	2
136	9392	WHEEL CAP LARGE RAL 7012	2
137	9408	CASTOR Ø75	1
138	9409	CASTOR WITH BRAKE Ø75	1
139	9361		1
140	74641	BOLT ELECTRICALLY CONDUCTING	1
144	9314		1
260	9433		
263	74450		
LABELS			
220		LABEL M-LABEL	1
221		LABEL FLAT-PLEATED FILTER	1
223		LABEL FILTER PAPER / PE-BAG	1
224	9389	LABEL PLUG SOCKET	1
SCREWS			
259	9434	SCREW 4x30 -10.9-R2R (K-In6Rd)	6
261	74948	SCREW 5x80 -10.9-R2R (K-In6Rd)	10
262	9428	SCREW 5x50 -10.9-R2R (K-In6Rd)	2
263	74450	SCREW 5x30 -10.9-R2R (K-In6Rd)	3
264	9427	SCREW 4x22 -ST-10.9-R2R (IN6RD)	6
265	74906	SCREW M4x8 -St-P2R (In6Rd)	1
266	9403	OVAL HEAD SCREW WITH HEX. SOCKET 4x16	1
267	74930	SCREW 4x16 -10.9-R2R (K-In6Rd)	4
268	9435	SCREW 5x130 -10.9-R2R (In6Rd)	4
271	9402	SCREW 3,5x12-10.9-R2R (IN6RD)	2
272	9432	SCREW 3,5x16 -10.9-A2E (In6Rd)	2
280	74963	SERRATED LCOK WASHER A4,3-1.4310 DIN 6798	1
281	9437	LOCK WASHER Ø 4,8x19	10
287	9405	LOCK WASHER	1
288	9406	LOCK WASHER 5	4
SET			
9590	9312		1
9502		HOUSING BASE PLATE SET	1
9502	9489		1
9511	9311		1
9524	9309		1
9552	9315		1
9502		HOUSING BASE PLATE	
2	9364	LOCK CLIP RAL 9005	2
3	9377	SENSOR	2
4	9404	LOCK WASHER	2
5	9400	SEALING HOUSING BASE PLATE	1
6	9415	CABLE SENSOR BLUE 0,5mm² x 490mm	2
7	9383	SPRING ELECTRICALLY CONDUCTING	1
8	74757	FAST FASTENER	1
9	74930	SCREW 4X16 -10.9-R2R (K-In6Rd)	1



BSS 608 H
ID-Nr.:09251
ab 01/08/2018

STATUS: 2020.11
REPLACED: -

POS	ArtikelNr.	DESCRIPTION	qty
ACCESSORIES			
500	9341	FILTER PAPER MAT 5 piece packed	1
501	9284	SLEEVE PACKED	1
502	9339		1
503	9276		1
504	73684		1
505			
506	10019		
507	9280	SUCTION HOSE PACKED ELECTRICALLY CONDUCTING	1
508	9279		1
509	9338	EQUIPMENT ASSORTMENT	1
510	9471		1
511	10039		1
	10118		1
	9108		1
	9278		
	8382		
	8283		
	9281		
	8600		



BSS608H ID: 9251
Stand/status: 2020.11
Ersetzt/replaced: 2018.08



2

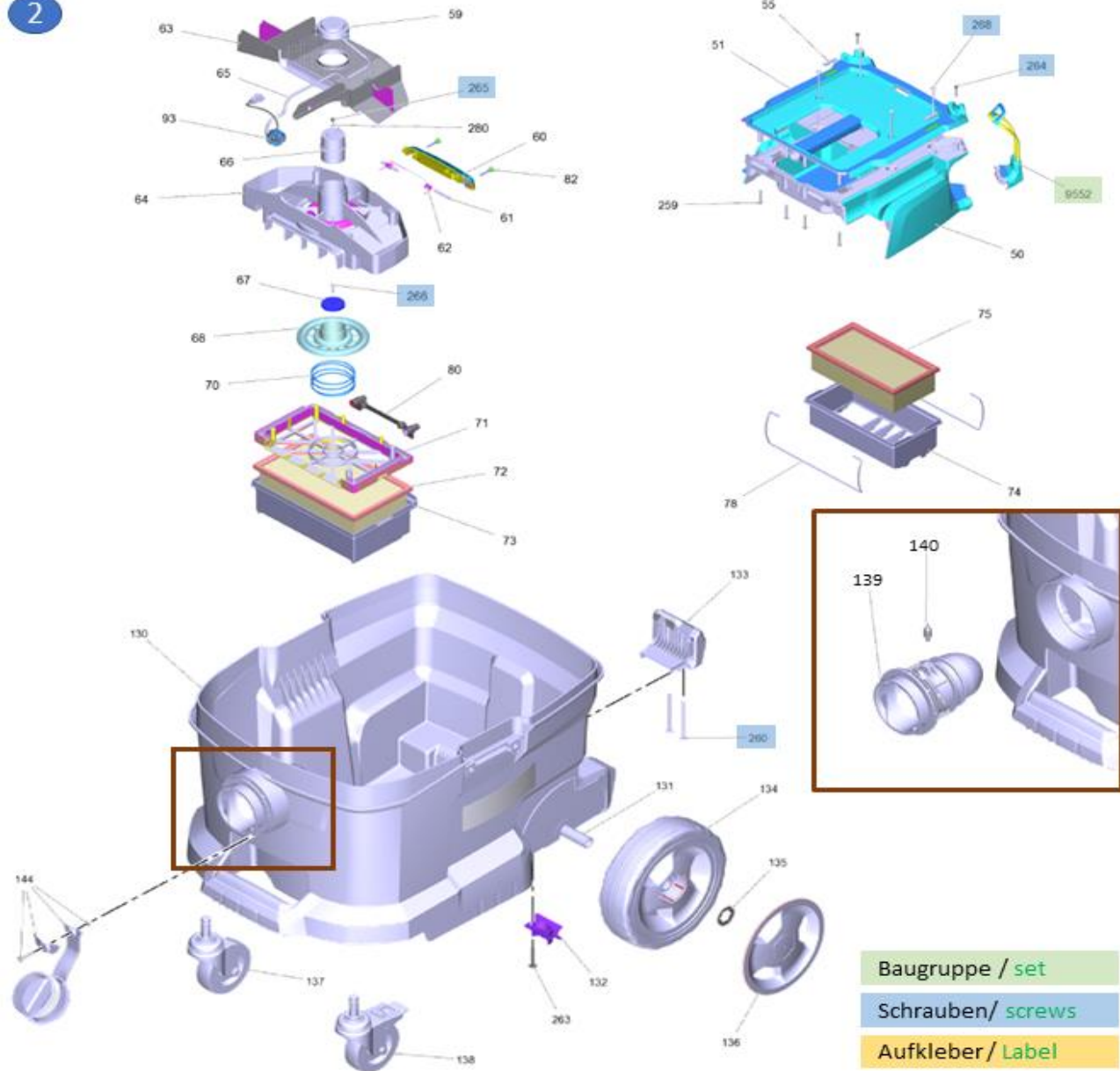



BSS608H ID: 9251
Stand/status: 2020.11
Ersetzt/replaced: 2018.08



3 GEHÄUSE GRUNDPLATTE SET/ HOUSING BASE PLATE SET
(Pos. 9502 auf Bild 1 / #9502 from picture 1)

